

THIS DRAWING IS TO BE READ IN CONJUNCTION WITH ALL RELEVANT SPECIFICATIONS AND DRAWINGS ISSUED. THIS DRAWING IS CORRECT AT TIME OF SURVEY

© COPYRIGHT FIRNTEC LTD 2022

BIRCH TREE COURT LEVEL 0

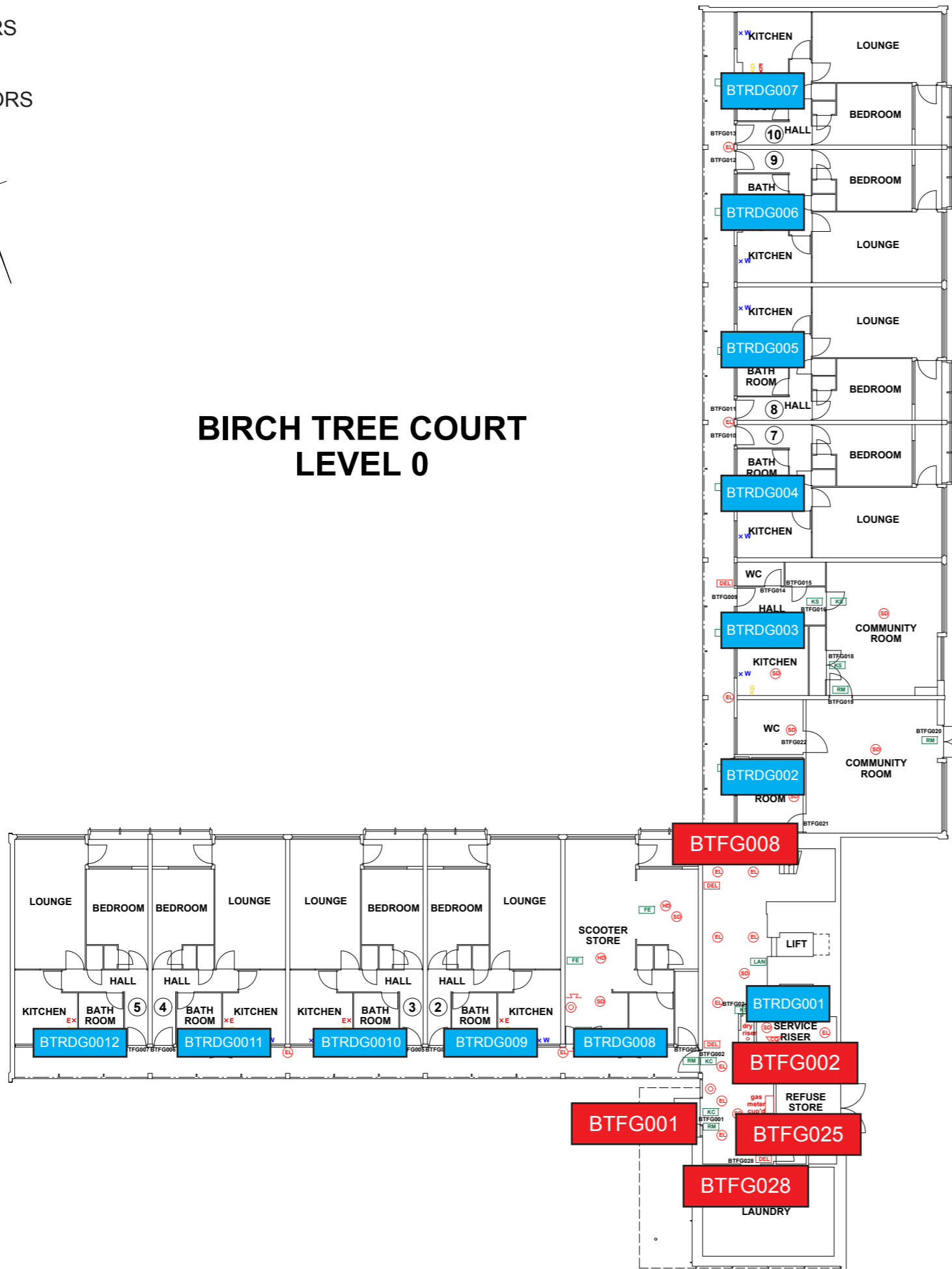

- FIRE PRECAUTIONS LEGEND**
- Break glass type fire alarm call point
 - Heat sensitive detectors
 - Smoke sensitive detectors
 - Emergency light point.
 - Firemans Switch
 - Emergency Drop Key Access
 - Fire alarm indicator / repeat panel
 - Door/Access fitted with Gerda D1 Key lock
 - Door/Access fitted with FB1 Key lock
 - Door/Access fitted with FB2 Key lock
 - Door/Access fitted with FB4 Key lock
 - Door/Access fitted with FB11 Padlock
 - Door/Access fitted with FB14 Padlock
 - Dry Riser Outlet
 - Digital electronic lock door entry/exit system
 - Premises Information Box
 - Permanently Open Vent
 - Automatic Opening Vent
 - Openable Vent
 - Fire alarm sounder ('X' indicates integral flashing - Xenon light)
 - CCTV Security Camera
 - Fire Brigade Key Access
 - EXTINGUISH**
 - 1.1m x 1.1m fire blanket - base of container to be 1500mm above floor level
 - 6 litres AFFF aqueous foam extinguisher to BS:6575
 - 9 litre wet chemical type extinguisher
 - 4.5 litre dry powder type extinguisher
 - 2 kg carbon dioxide type extinguisher
 - 4.5 kg carbon dioxide type extinguisher
 - 9 kg water type extinguisher
 - 6 litre water type extinguisher
 - FIRE EXIT SIGNAGE**
 - 'E' Signs to be externally illuminated by adjacent emergency light point
 - 'FE' denotes as previous but illuminated as part of sign
 - 'RM' denotes non illuminated sign
 - FIRE DOOR SIGNS AND FIRE ACTION NOTICES**
 - Fire Action Notice
 - Emergency Floor Plan
 - "FIRE DOOR KEEP SHUT" sign
 - "FIRE DOOR KEEP LOCKED" sign
 - "AUTOMATIC FIRE DOOR KEEP CLEAR" or "FIRE EXIT KEEP CLEAR" sign
 - "CAUTION, IN THE EVENT OF FIRE DO NOT USE THIS LIFT"
 - DISTRIBUTION BOARD



REV	DATE	AMENDMENTS

WEB: WWW.FIRNTEC.COM
 EMAIL: CONTACTUS@FIRNTEC.COM
 ADDRESS: 1ST FLOOR, ENDEAVOUR HOUSE, PARKWAY CT, PLYMOUTH PL6 6LR
 TEL: 01752 977 147

PROJECT: BIRCH TREE COURT
 ADDRESS: BIRCH TREE COURT, WYTHENSHAW, MANCHESTER, M22 5RY
 DWG NO.: BTC_220201_01
 DWG TITLE: LEVEL 0
 DWG DATE: NOVEMBER 2022
 DWG SIZE: SCALE 1:100 @ A1
 DRAWN: NR | CHECKED: BR

- FIRE DOORS
- RISER DOORS

THIS DRAWING IS TO BE READ IN CONJUNCTION WITH ALL RELEVANT SPECIFICATIONS AND DRAWINGS ISSUED. THIS DRAWING IS CORRECT AT TIME OF SURVEY

© COPYRIGHT FIRNTEC LTD 2022

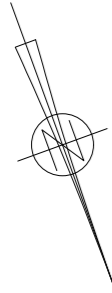

BIRCH TREE COURT LEVEL 1

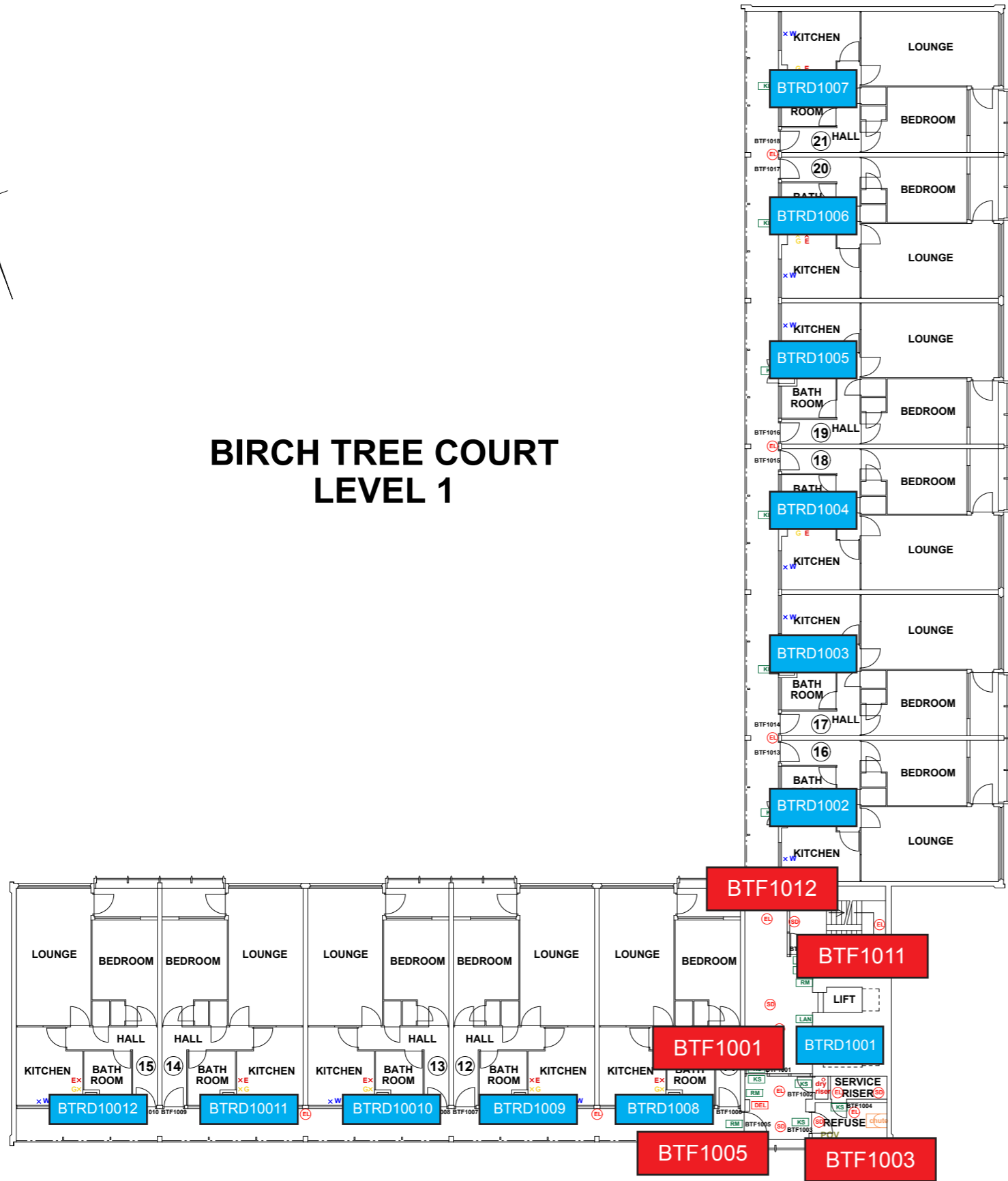

- ### FIRE PRECAUTIONS LEGEND
- ⊙ Break glass type fire alarm call point
 - ⊕ Heat sensitive detectors
 - ⊖ Smoke sensitive detectors
 - ⊕ Emergency light point.
 - ⊕ Firemans Switch
 - ⊕ Emergency Drop Key Access
 - FAP Fire alarm indicator / repeat panel
 - GD1 Door/Access fitted with Gerda D1 Key lock
 - FB1 Door/Access fitted with FB1 Key lock
 - FB2 Door/Access fitted with FB2 Key lock
 - FB4 Door/Access fitted with FB4 Key lock
 - FB11 Door/Access fitted with FB11 Padlock
 - FB14 Door/Access fitted with FB14 Padlock
 - DRO Dry Riser Outlet
 - DEL Digital electronic lock door entry/exit system
 - PIB Premises Information Box
 - POV Permanently Open Vent
 - AOV Automatic Opening Vent
 - OV Openable Vent
 - X Fire alarm sounder ("X" indicates integral flashing - Xenon light)
 - CCTV CCTV Security Camera
 - FB Fire Brigade Key Access
 - EXTINGUISH**
 - BLNH 1.1m x 1.1m fire blanket - base of container to be 1500mm above floor level
 - A 6 litres AFFF aqueous foam extinguisher to BS:6575
 - W 9 litre wet chemical type extinguisher
 - D 4.5 litre dry powder type extinguisher
 - C 2 kg carbon dioxide type extinguisher
 - C 4.5 kg carbon dioxide type extinguisher
 - W 9 kg water type extinguisher
 - W 6 litre water type extinguisher
 - FIRE EXIT SIGNAGE**
 - E 'E' Signs to be externally illuminated by adjacent emergency light point
 - FE 'FE' denotes as previous but illuminated as part of sign
 - RM 'RM' denotes non illuminated sign
 - FIRE DOOR SIGNS AND FIRE ACTION NOTICES**
 - FAN Fire Action Notice
 - EFP Emergency Floor Plan
 - KS "FIRE DOOR KEEP SHUT" sign
 - KL "FIRE DOOR KEEP LOCKED" sign
 - KC "AUTOMATIC FIRE DOOR KEEP CLEAR" or "FIRE EXIT KEEP CLEAR" sign
 - LAN "CAUTION, IN THE EVENT OF FIRE DO NOT USE THIS LIFT"
 - DB DISTRIBUTION BOARD

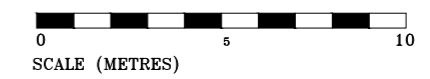

REV	DATE	AMENDMENTS

WEB: WWW.FIRNTEC.COM
 EMAIL: CONTACTUS@FIRNTEC.COM
 ADDRESS: 1ST FLOOR, ENDEAVOUR HOUSE, PARKWAY CT, PLYMOUTH PL6 6LR
 TEL: 01752 977 147

PROJECT: BIRCH TREE COURT
 ADDRESS: BIRCH TREE COURT, WYTHENSHAW, MANCHESTER, M22 5RY
 DWG NO.: BTC_2200201_02
 DWG TITLE: LEVEL 1
 DWG DATE: NOVEMBER 2022
 DWG SIZE: SCALE 1:100 @ A1
 DRAWN: NR | CHECKED: BR

- FIRE DOORS
- RISER DOORS

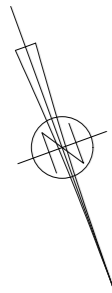

BIRCH TREE COURT LEVEL 2

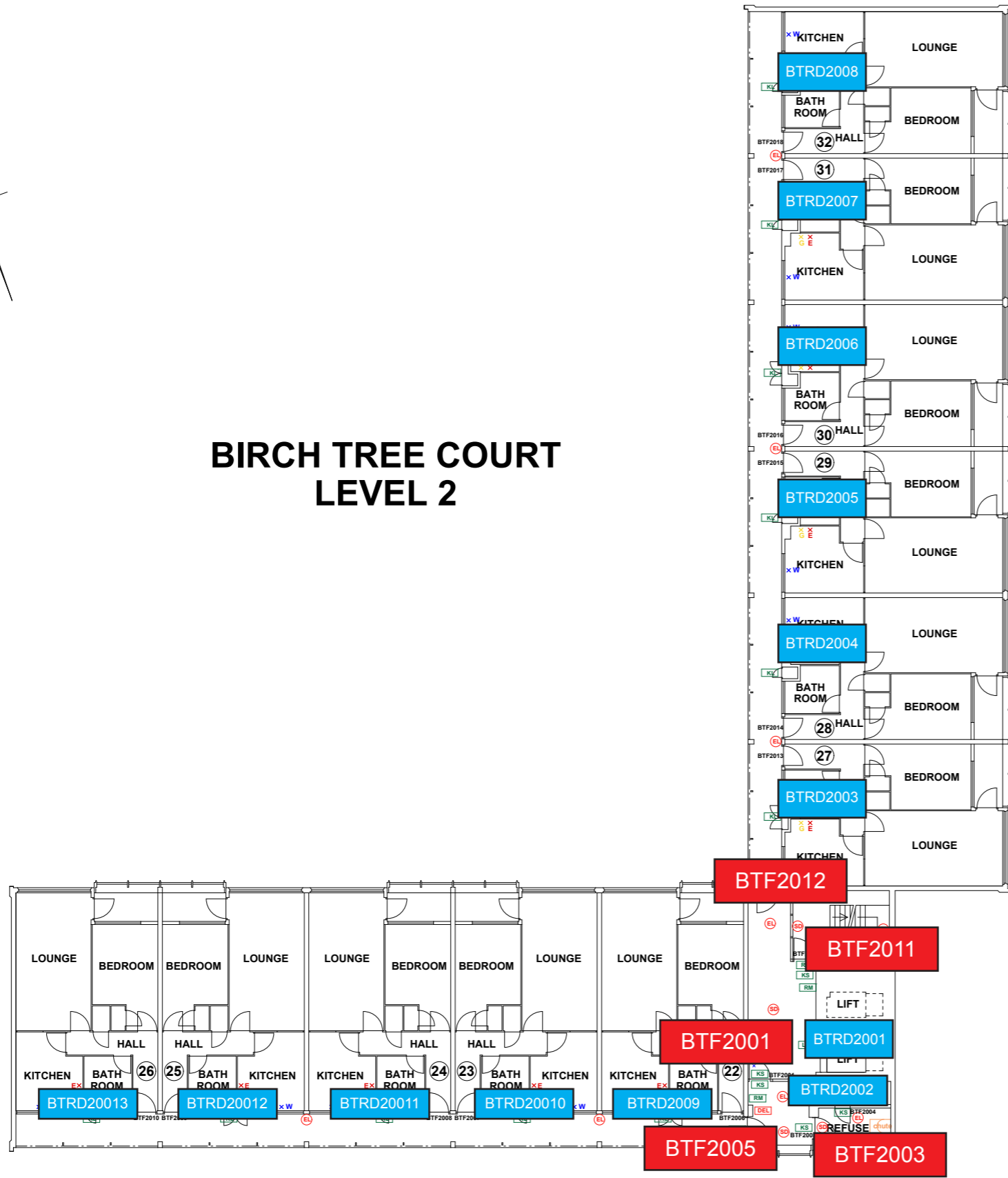

THIS DRAWING IS TO BE READ IN CONJUNCTION WITH ALL RELEVANT SPECIFICATIONS AND DRAWINGS ISSUED. THIS DRAWING IS CORRECT AT TIME OF SURVEY

© COPYRIGHT FIRNTEC LTD 2022

- FIRE PRECAUTIONS LEGEND**
- Break glass type fire alarm call point
 - HD Heat sensitive detectors
 - SD Smoke sensitive detectors
 - EL Emergency light point.
 - FS Firemans Switch
 - OKA Emergency Drop Key Access
 - FAP Fire alarm indicator / repeat panel
 - GD1 Door/Access fitted with Gerda D1 Key lock
 - FB1 Door/Access fitted with FB1 Key lock
 - FB2 Door/Access fitted with FB2 Key lock
 - FB4 Door/Access fitted with FB4 Key lock
 - FB11 Door/Access fitted with FB11 Padioclock
 - FB14 Door/Access fitted with FB14 Padioclock
 - DRO Dry Riser Outlet
 - DEL Digital electronic lock door entry/exit system
 - PIB Premises Information Box
 - POV Permanently Open Vent
 - AOV Automatic Opening Vent
 - OV Openable Vent
 - /- Fire alarm sounder ('X' indicates integral flashing - Xenon light)
 - CCTV CCTV Security Camera
 - FB Fire Brigade Key Access
- EXTINGUISH**
- BLNY 1.1m x 1.1m fire blanket - base of container to be 1500mm above floor level
 - AFFF 6 litres AFFF aqueous foam extinguisher to BS:6575
 - W 9 litre wet chemical type extinguisher
 - DP 4.5 litre dry powder type extinguisher
 - CD 2 kg carbon dioxide type extinguisher
 - CD 4.5 kg carbon dioxide type extinguisher
 - W 9 kg water type extinguisher
 - W 6 litre water type extinguisher
- FIRE EXIT SIGNAGE**
- E 'E' Signs to be externally illuminated by adjacent emergency light point
 - FE 'FE' denotes as previous but illuminated as part of sign
 - RM 'RM' denotes non illuminated sign
- FIRE DOOR SIGNS AND FIRE ACTION NOTICES**
- FAN Fire Action Notice
 - EFP Emergency Floor Plan
 - KS "FIRE DOOR KEEP SHUT" sign
 - KL "FIRE DOOR KEEP LOCKED" sign
 - KC "AUTOMATIC FIRE DOOR KEEP CLEAR" or "FIRE EXIT KEEP CLEAR" sign
 - LAN "CAUTION, IN THE EVENT OF FIRE DO NOT USE THIS LIFT" sign
 - DB DISTRIBUTION BOARD



REV	DATE	AMENDMENTS

WEB: WWW.FIRNTEC.COM
 EMAIL: CONTACT@FIRNTEC.COM
 ADDRESS: 1ST FLOOR, ENDEAVOUR HOUSE, PARKWAY CT, PLYMOUTH PL6 6LR
 TEL: 01752 971 147

PROJECT: BIRCH TREE COURT

ADDRESS: BIRCH TREE COURT
WYTHENSHAW
MANCHESTER
M22 5RY

DWG NO.: BTC_220020_L03
 DWG TITLE: LEVEL 2
 DWG DATE: NOVEMBER 2022
 DWG SIZE: SCALE 1:100 @ A1
 DRAWN: NR | CHECKED: BR | ISSUED:

- FIRE DOORS
- RISER DOORS

THIS DRAWING IS TO BE READ IN CONJUNCTION WITH ALL RELEVANT SPECIFICATIONS AND DRAWINGS ISSUED. THIS DRAWING IS CORRECT AT TIME OF SURVEY

© COPYRIGHT FIRNTEC LTD 2022

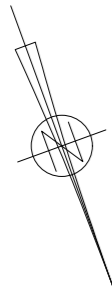

BIRCH TREE COURT LEVEL 3

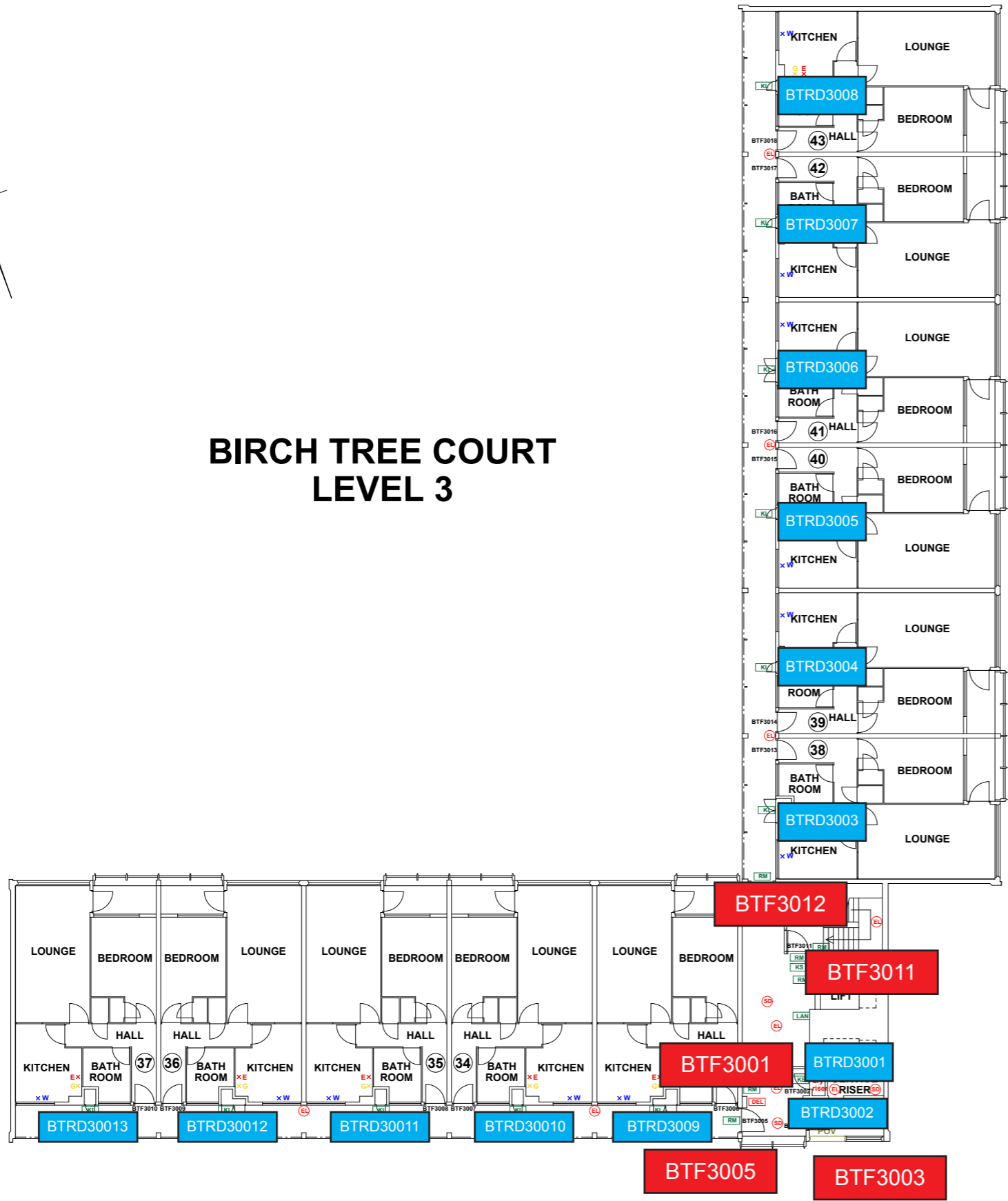

- ### FIRE PRECAUTIONS LEGEND
- ⊙ Break glass type fire alarm call point
 - ⊕ Heat sensitive detectors
 - ⊗ Smoke sensitive detectors
 - ⊕ Emergency light point.
 - ⊕ Firemans Switch
 - ⊕ Emergency Drop Key Access
 - ⊕ Fire alarm indicator / repeat panel
 - ⊕ Door/Access fitted with Gerda D1 Key lock
 - ⊕ Door/Access fitted with FB1 Key lock
 - ⊕ Door/Access fitted with FB2 Key lock
 - ⊕ Door/Access fitted with FB4 Key lock
 - ⊕ Door/Access fitted with FB11 Padlock
 - ⊕ Door/Access fitted with FB14 Padlock
 - ⊕ Dry Riser Outlet
 - ⊕ Digital electronic lock door entry/exit system
 - ⊕ Premises Information Box
 - ⊕ Permanently Open Vent
 - ⊕ Automatic Opening Vent
 - ⊕ Openable Vent
 - X- Fire alarm sounder ('X' indicates integral flashing - Xenon light)
 - CCTV CCTV Security Camera
 - FB Fire Brigade Key Access
 - EXTINGUISH**
 - BLNKT 1.1m x 1.1m fire blanket - base of container to be 1500mm above floor level
 - X 6 litres AFFF aqueous foam extinguisher to BS-6575
 - X 9 litre wet chemical type extinguisher
 - X 4.5 litre dry powder type extinguisher
 - X 2 kg carbon dioxide type extinguisher
 - X 4.5 kg carbon dioxide type extinguisher
 - X 9 kg water type extinguisher
 - X 6 litre water type extinguisher
 - FIRE EXIT SIGNAGE**
 - E 'E' Signs to be externally illuminated by adjacent emergency light point
 - FE 'FE' denotes as previous but illuminated as part of sign
 - RM 'RM' denotes non illuminated sign
 - FIRE DOOR SIGNS AND FIRE ACTION NOTICES**
 - FAN Fire Action Notice
 - EFP Emergency Floor Plan
 - KS "FIRE DOOR KEEP SHUT" sign
 - KL "FIRE DOOR KEEP LOCKED" sign
 - KC "AUTOMATIC FIRE DOOR KEEP CLEAR" or "FIRE EXIT KEEP CLEAR" sign
 - LAN "CAUTION, IN THE EVENT OF FIRE DO NOT USE THIS LIFT"
 - DB DISTRIBUTION BOARD

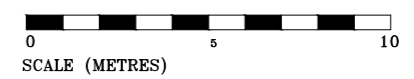

REV	DATE	AMENDMENTS

WWW.FIRNTEC.COM
CONTACT@FIRNTEC.COM
187 FLOOR, ENDEAVOUR HOUSE,
PARKWAY CT, PLUMBOOTH PLE BLK
01762 877 147

PROJECT: BIRCH TREE COURT

ADDRESS: BIRCH TREE COURT
WYTHENSHAW
MANCHESTER
M22 5RY

DWG NO.: BTC_220020L04
DWG TITLE: LEVEL 3
DWG DATE: NOVEMBER 2022
DWG SIZE: SCALE 1:100 @ A1
DRAWN: NR | CHECKED: BR | ISSUE

- FIRE DOORS
- RISER DOORS

THIS DRAWING IS TO BE READ IN CONJUNCTION WITH ALL RELEVANT SPECIFICATIONS AND DRAWINGS ISSUED. THIS DRAWING IS CORRECT AT TIME OF SURVEY

© COPYRIGHT FIRNTEC LTD 2022

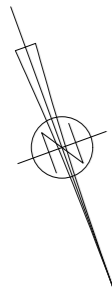

BIRCH TREE COURT LEVEL 4

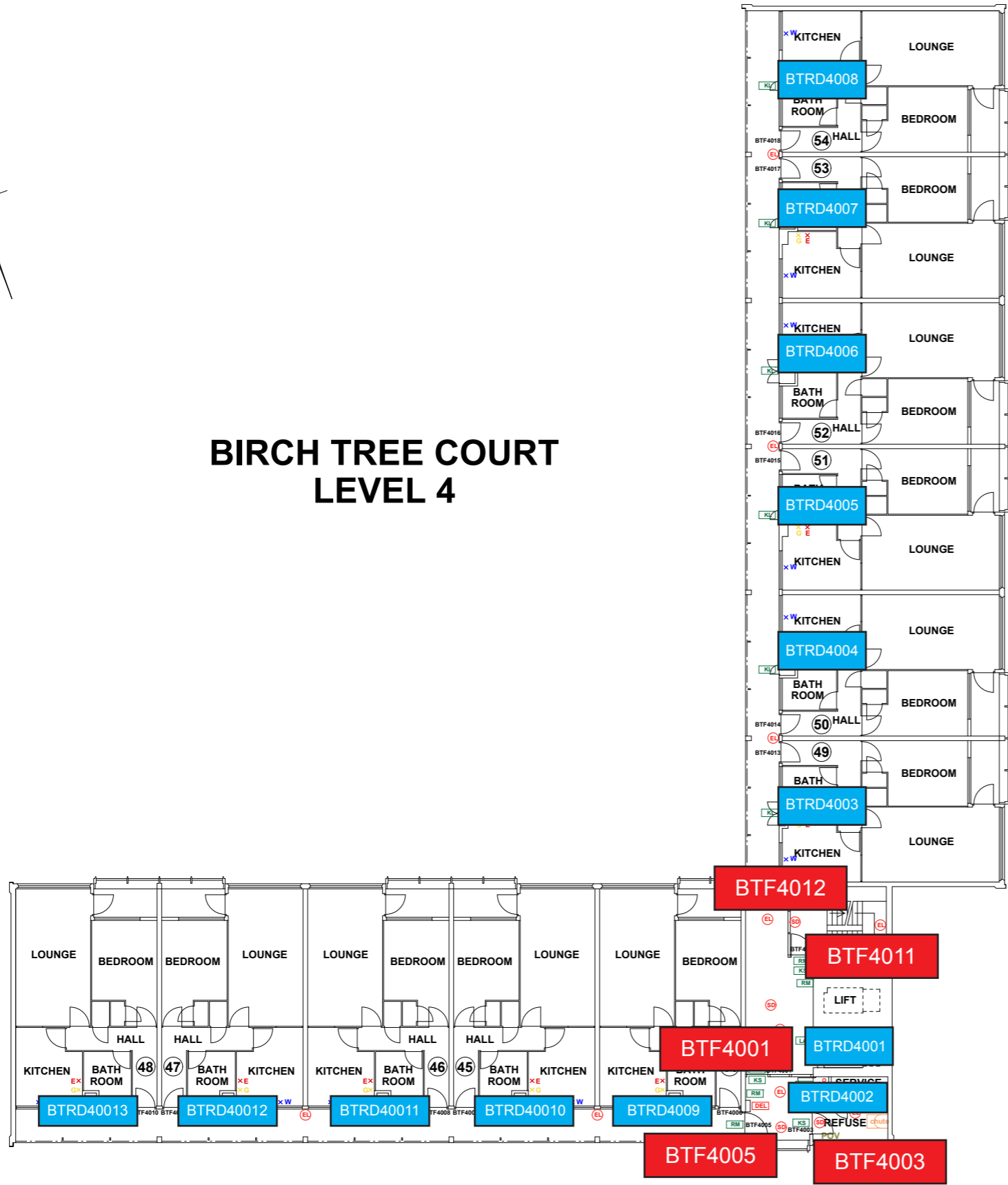

- ### FIRE PRECAUTIONS LEGEND
- ⊙ Break glass type fire alarm call point
 - ⊕ Heat sensitive detectors
 - ⊕ Smoke sensitive detectors
 - ⊕ Emergency light point.
 - ⊕ Firemans Switch
 - ⊕ Emergency Drop Key Access
 - TAP Fire alarm indicator / repeat panel
 - GD1 Door/Access fitted with Gerda D1 Key lock
 - FB1 Door/Access fitted with FB1 Key lock
 - FB2 Door/Access fitted with FB2 Key lock
 - FB4 Door/Access fitted with FB4 Key lock
 - FB1P Door/Access fitted with FB11 Padlock
 - FB1P Door/Access fitted with FB14 Padlock
 - BRO Dry Riser Outlet
 - DEL Digital electronic lock door entry/exit system
 - PIB Premises Information Box
 - POV Permanently Open Vent
 - AOV Automatic Opening Vent
 - OV Openable Vent
 - S- Fire alarm sounder ('X' indicates integral flashing - Xenon light)
 - CCTV CCTV Security Camera
 - FB Fire Brigade Key Access
 - EXTINGUISH**
 - BLNR 1.1m x 1.1m fire blanket - base of container to be 150mm above floor level
 - AFFF 6 litres AFFF aqueous foam extinguisher to BS:6575
 - W 9 litre wet chemical type extinguisher
 - DP 4.5 litre dry powder type extinguisher
 - CD 2 kg carbon dioxide type extinguisher
 - CD 4.5 kg carbon dioxide type extinguisher
 - W 9 kg water type extinguisher
 - W 6 litre water type extinguisher
 - FIRE EXIT SIGNAGE**
 - E 'E' Signs to be externally illuminated by adjacent emergency light point
 - FE 'FE' denotes as previous but illuminated as part of sign
 - RM 'RM' denotes non illuminated sign
 - FIRE DOOR SIGNS AND FIRE ACTION NOTICES**
 - FAN Fire Action Notice
 - EFP Emergency Floor Plan
 - KS "FIRE DOOR KEEP SHUT" sign
 - KL "FIRE DOOR KEEP LOCKED" sign
 - KC "AUTOMATIC FIRE DOOR KEEP CLEAR" or "FIRE EXIT KEEP CLEAR" sign
 - LAN "CAUTION, IN THE EVENT OF FIRE DO NOT USE THIS LIFT"
 - DB DISTRIBUTION BOARD

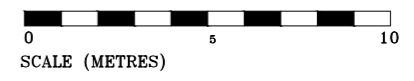

REV	DATE	AMENDMENTS

WEB: WWW.FIRNTEC.COM
 EMAIL: CONTACT@FIRNTEC.COM
 ADDRESS: 1ST FLOOR, ENDEAVOUR HOUSE, PARKWAY CT, PLYMOUTH PL6 8LR
 TEL: 01752 977 147

PROJECT: BIRCH TREE COURT
 ADDRESS: BIRCH TREE COURT
 WYTHENSHAW
 MANCHESTER
 M22 5RY

DWG NO.: BTC_2200201_05
 DWG TITLE: LEVEL 4
 DWG DATE: NOVEMBER 2022
 DWG SIZE: SCALE 1:100 @ A1
 DRAWN: NR CHECKED: BR

- FIRE DOORS
- RISER DOORS

THIS DRAWING IS TO BE READ IN CONJUNCTION WITH ALL RELEVANT SPECIFICATIONS AND DRAWINGS ISSUED. THIS DRAWING IS CORRECT AT TIME OF SURVEY.

© COPYRIGHT FIRNTEC LTD 2022

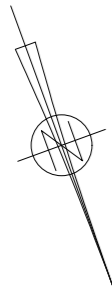

BIRCH TREE COURT LEVEL 5

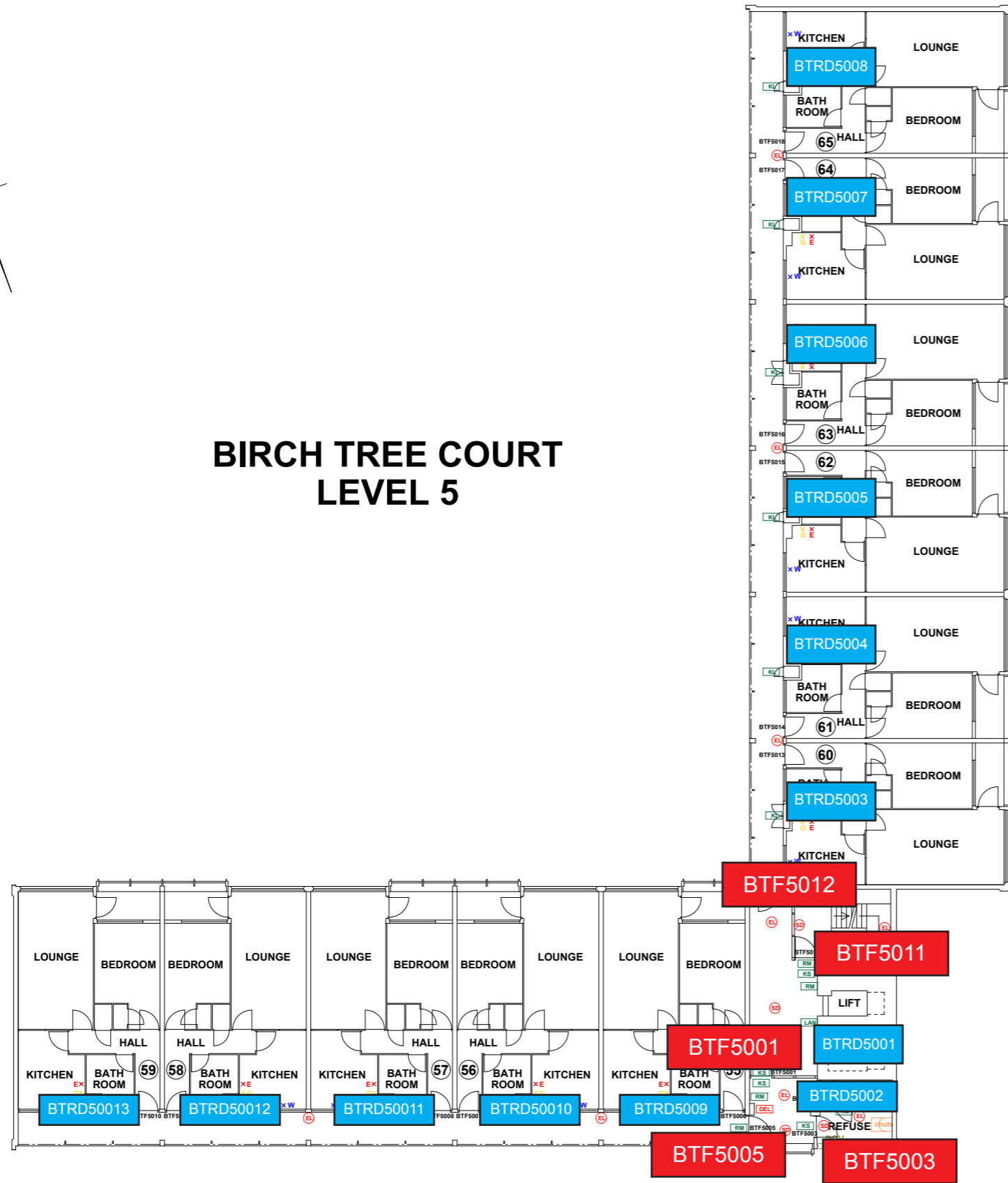

- ### FIRE PRECAUTIONS LEGEND
- ⊙ Break glass type fire alarm call point
 - ⊕ Heat sensitive detectors
 - ⊕ Smoke sensitive detectors
 - ⊕ Emergency light point.
 - ⊕ Firemans Switch
 - ⊕ Emergency Drop Key Access
 - ⊕ Fire alarm indicator / repeat panel
 - ⊕ Door/Access fitted with Gerda D1 Key lock
 - ⊕ Door/Access fitted with FB1 Key lock
 - ⊕ Door/Access fitted with FB2 Key lock
 - ⊕ Door/Access fitted with FB4 Key lock
 - ⊕ Door/Access fitted with FB11 Padlock
 - ⊕ Door/Access fitted with FB14 Padlock
 - ⊕ Dry Riser Outlet
 - ⊕ Digital electronic lock door entry/exit system
 - ⊕ Premises Information Box
 - ⊕ Permanently Open Vent
 - ⊕ Automatic Opening Vent
 - ⊕ Openable Vent
 - L Fire alarm sounder ('X' indicates integral flashing - Xenon light)
 - CCTV CCTV Security Camera
 - FB Fire Brigade Key Access
 - EXTINGUISH**
 - BLNK 1.1m x 1.1m fire blanket - base of container to be 1500mm above floor level
 - V6 6 litres AFFF aqueous foam extinguisher to BS:6575
 - V9 9 litre wet chemical type extinguisher
 - V4.5 4.5 litre dry powder type extinguisher
 - V2 2 kg carbon dioxide type extinguisher
 - V4.5 4.5 kg carbon dioxide type extinguisher
 - V9 9 kg water type extinguisher
 - V6 6 litre water type extinguisher
 - FIRE EXIT SIGNAGE**
 - E 'E' Signs to be externally illuminated by adjacent emergency light point
 - FE 'FE' denotes as previous but illuminated as part of sign
 - RM 'RM' denotes non illuminated sign
 - FIRE DOOR SIGNS AND FIRE ACTION NOTICES**
 - FAM Fire Action Notice
 - EFP Emergency Floor Plan
 - KS "FIRE DOOR KEEP SHUT" sign
 - KL "FIRE DOOR KEEP LOCKED" sign
 - KC "AUTOMATIC FIRE DOOR KEEP CLEAR" or "FIRE EXIT KEEP CLEAR" sign
 - LAN "CAUTION, IN THE EVENT OF FIRE DO NOT USE THIS LIFT"
 - DB DISTRIBUTION BOARD

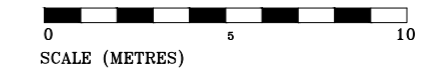

REV	DATE	AMENDMENTS

WEB: WWW.FIRNTEC.COM
 EMAIL: CONTACTUS@FIRNTEC.COM
 ADDRESS: 1ST FLOOR, ENDEAVOUR HOUSE, PARKWAY CT, PLYMOUTH PL6 6LR
 TEL: 01752 977 147

PROJECT: BIRCH TREE COURT
 ADDRESS: BIRCH TREE COURT
 WYTHENSHAW
 MANCHESTER
 M22 5RY
 DWG NO.: B7C_220020L_06
 DWG TITLE: LEVEL 5
 DWG DATE: NOVEMBER 2022
 DWG SIZE: SCALE 1:100 @ A1
 DRAWN: NR | CHECKED: BR

- FIRE DOORS
- RISER DOORS

THIS DRAWING IS TO BE READ IN CONJUNCTION WITH ALL RELEVANT SPECIFICATIONS AND DRAWINGS ISSUED. THIS DRAWING IS CORRECT AT TIME OF SURVEY

© COPYRIGHT FIRNTEC LTD 2022

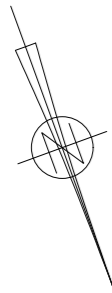

BIRCH TREE COURT LEVEL 6

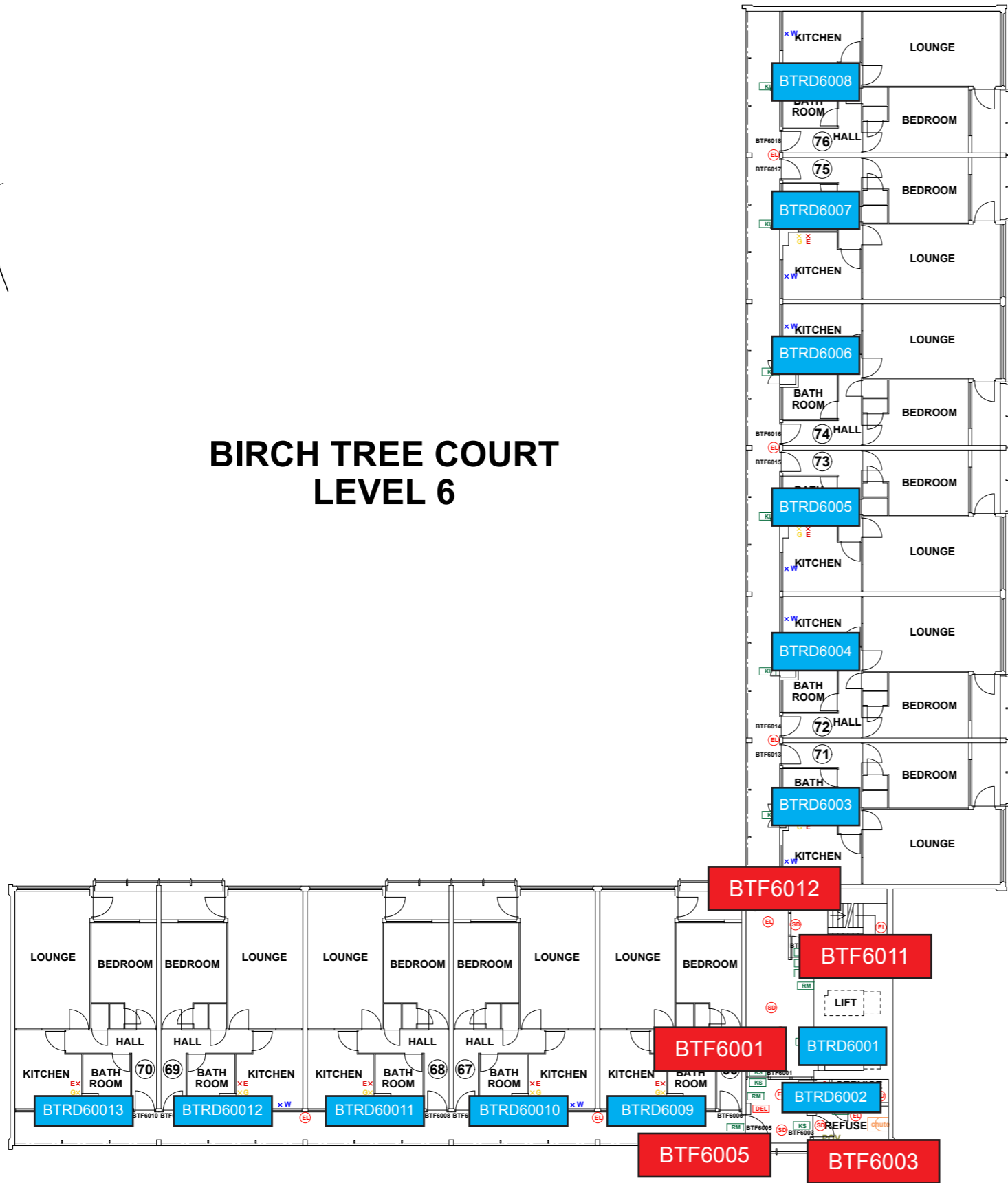

- ### FIRE PRECAUTIONS LEGEND
- Break glass type fire alarm call point
 - ⊕ Heat sensitive detectors
 - ⊙ Smoke sensitive detectors
 - ⊕ Emergency light point.
 - ⊕ Firemans Switch
 - ⊕ Emergency Drop Key Access
 - FAP Fire alarm indicator / repeat panel
 - GD1 Door/Access fitted with Gerda D1 Key lock
 - FB1 Door/Access fitted with FB1 Key lock
 - FB2 Door/Access fitted with FB2 Key lock
 - FB4 Door/Access fitted with FB4 Key lock
 - FB11 Door/Access fitted with FB11 Padlock
 - FB14 Door/Access fitted with FB14 Padlock
 - DRO Dry Riser Outlet
 - DEL Digital electronic lock door entry/exit system
 - PIB Premises Information Box
 - POV Permanently Open Vent
 - AOV Automatic Opening Vent
 - OV Openable Vent
 - /- Fire alarm sounder ('X' indicates integral flashing - Xenon light)
 - CCTV CCTV Security Camera
 - FB Fire Brigade Key Access
- ### EXTINGUISH
- BLNHT 1.1m x 1.1m fire blanket - base of container to be 1500mm above floor level
 - AFFF 6 litres AFFF aqueous foam extinguisher to BS:675
 - W 9 litre wet chemical type extinguisher
 - D 4.5 litre dry powder type extinguisher
 - C 2 kg carbon dioxide type extinguisher
 - CD 4.5 kg carbon dioxide type extinguisher
 - W 9 kg water type extinguisher
 - W 6 litre water type extinguisher
- ### FIRE EXIT SIGNAGE
- E 'E' Signs to be externally illuminated by adjacent emergency light point
 - FE 'FE' denotes as previous but illuminated as part of sign
 - RM 'RM' denotes non illuminated sign
- ### FIRE DOOR SIGNS AND FIRE ACTION NOTICES
- FAN Fire Action Notice
 - EFP Emergency Floor Plan
 - KS "FIRE DOOR KEEP SHUT" sign
 - KL "FIRE DOOR KEEP LOCKED" sign
 - KC "AUTOMATIC FIRE DOOR KEEP CLEAR" or "FIRE EXIT KEEP CLEAR" sign
 - LAN "CAUTION, IN THE EVENT OF FIRE DO NOT USE THIS LIFT"
 - DB DISTRIBUTION BOARD

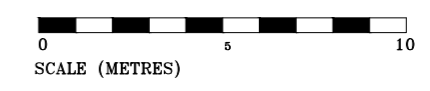

REV	DATE	AMENDMENTS

WEB: WWW.FIRNTEC.COM
 EMAIL: CONTACTUS@FIRNTEC.COM
 ADDRESS: 1ST FLOOR, ENDEAVOUR HOUSE,
 PARKWAY CT, PLIMMOUTH PL 6 6LJ
 TEL: 01752 877 147

PROJECT: BIRCH TREE COURT
 ADDRESS: BIRCH TREE COURT
 WYTHENSHAW
 MANCHESTER
 M22 5RY
 DWG NO.: BTC_220020L07
 DWG TITLE: LEVEL 6
 DWG DATE: NOVEMBER 2022
 DWG SIZE: SCALE 1:100 @ A1
 DRAWN: NR | CHECKED: BR | ISSUED:

- FIRE DOORS
- RISER DOORS

THIS DRAWING IS TO BE READ IN CONJUNCTION WITH ALL RELEVANT SPECIFICATIONS AND DRAWINGS ISSUED. THIS DRAWING IS CORRECT AT TIME OF SURVEY

© COPYRIGHT FIRNTEC LTD 2022

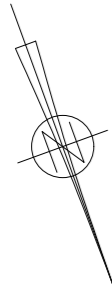

BIRCH TREE COURT LEVEL 7

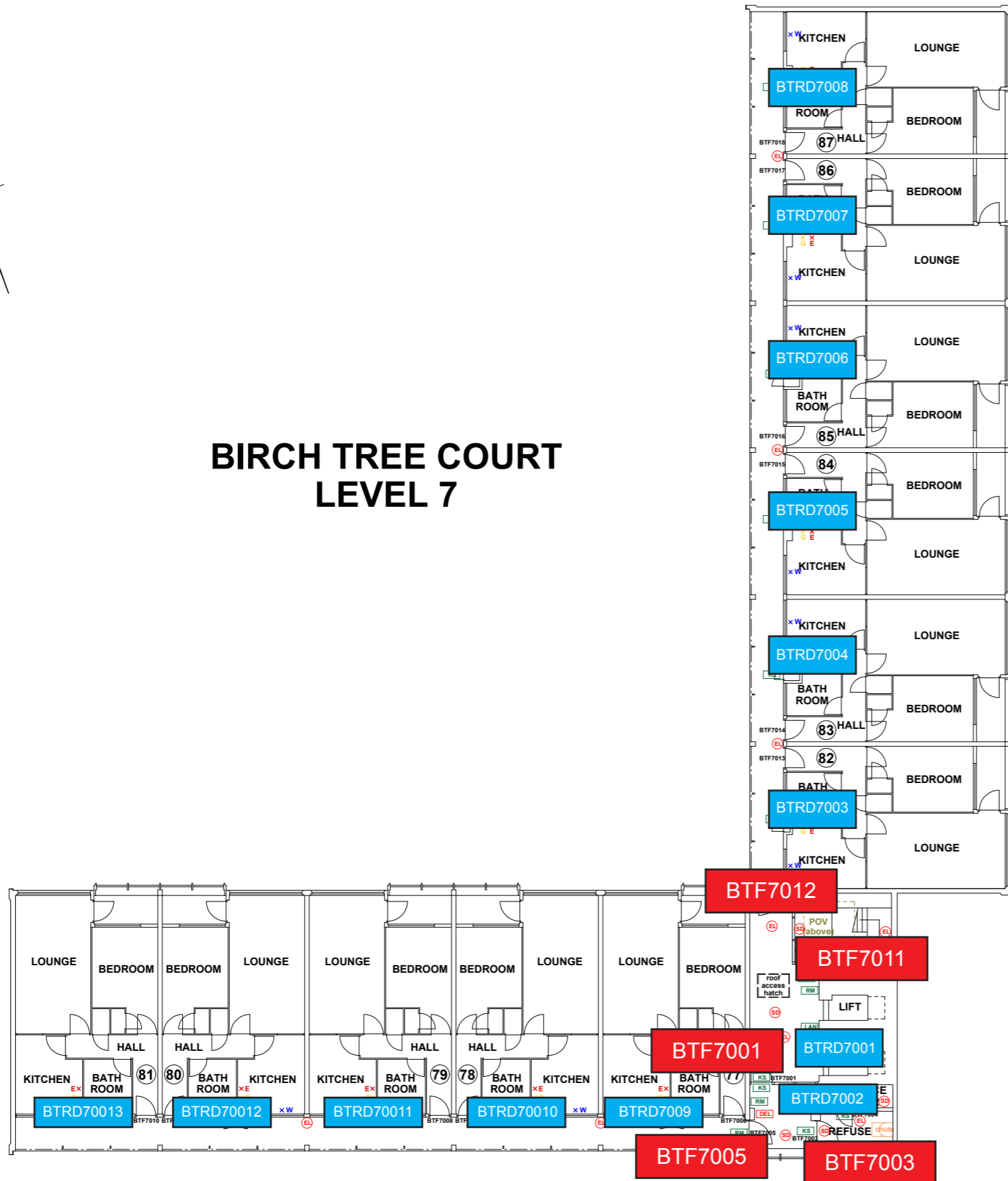

- FIRE PRECAUTIONS LEGEND**
- ⊙ Break glass type fire alarm call point
 - ⊕ Heat sensitive detectors
 - ⊖ Smoke sensitive detectors
 - ⊕ Emergency light point.
 - ⊕ Firemans Switch
 - ⊕ Emergency Drop Key Access
 - FAP Fire alarm indicator / repeat panel
 - D1 Door/Access fitted with Garda D1 Key lock
 - FB1 Door/Access fitted with FB1 Key lock
 - FB2 Door/Access fitted with FB2 Key lock
 - FB4 Door/Access fitted with FB4 Key lock
 - FB11 Door/Access fitted with FB11 Padlock
 - FB14 Door/Access fitted with FB14 Padlock
 - RO Dry Riser Outlet
 - DEL Digital electronic lock door entry/exit system
 - PIB Premises Information Box
 - POV Permanently Open Vent
 - AOV Automatic Opening Vent
 - OV Openable Vent
 - S Fire alarm sounder ("X" indicates integral flashing - Xenon light)
 - CCTV CCTV Security Camera
 - FB Fire Brigade Key Access
 - EXTINGUISH**
 - BLANKET 1.1m x 1.1m fire blanket - base of container to be 1500mm above floor level
 - 6L 6 litres AFFF aqueous foam extinguisher to BS:6575
 - 9L 9 litre wet chemical type extinguisher
 - 4.5L 4.5 litre dry powder type extinguisher
 - 2kg 2 kg carbon dioxide type extinguisher
 - 4.5kg 4.5 kg carbon dioxide type extinguisher
 - 9kg 9 kg water type extinguisher
 - 6L 6 litre water type extinguisher
 - FIRE EXIT SIGNAGE**
 - E 'E' Signs to be externally illuminated by adjacent emergency light point
 - FE 'FE' denotes as previous but illuminated as part of sign
 - RM 'RM' denotes non illuminated sign
 - FIRE DOOR SIGNS AND FIRE ACTION NOTICES**
 - FAN Fire Action Notice
 - EFP Emergency Floor Plan
 - KS "FIRE DOOR KEEP SHUT" sign
 - KL "FIRE DOOR KEEP LOCKED" sign
 - KC "AUTOMATIC FIRE DOOR KEEP CLEAR" or "FIRE EXIT KEEP CLEAR" sign
 - LAN "CAUTION, IN THE EVENT OF FIRE DO NOT USE THIS LIFT"
 - DB DISTRIBUTION BOARD

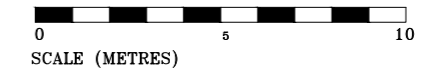

REV	DATE	AMENDMENTS

WEB: WWW.FIRNTEC.COM
EMAIL: CONTACTUS@FIRNTEC.COM
ADDRESS: 1ST FLOOR, ENDEAVOUR HOUSE, PARKWAY CT, PLTWOODHILL BLK

PROJECT: BIRCH TREE COURT
ADDRESS: BIRCH TREE COURT, WYTHENSHAW, MANCHESTER, M22 5RY

DWG NO.: BTC_220020L08
DWG TITLE: LEVEL 7
DWG DATE: NOVEMBER 2022
DWG SIZE: SCALE 1:100 @ A1
DRAWN: NR | CHECKED: BR